

**PLEASE READ
BEFORE COMMENCING
OPERATION**

This machine is suitable for DRY
use only.

Make sure that the filtration system
fitted to the machine is suitable for
the material being collected.

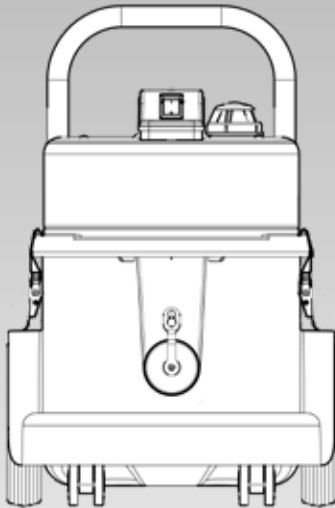

HZC 390S-2

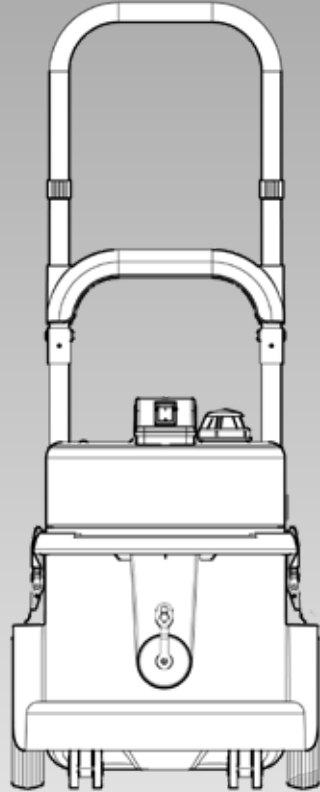

HZC 390L-2



Owner Instructions

Warning! Read the Instructions before using the machine.

HZC 390S-2 / HZC 390L-2

1000W (Kit AA16)



www.numatic.co.uk

Kit AA16

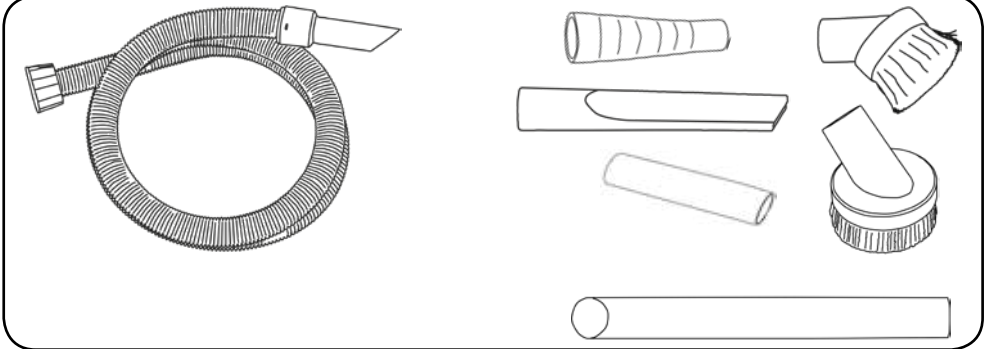

601101 2.4 NuFlex Threaded Hose

602161 152mm Rubber Dusting Brush with soft bristles

601142 240mm Crevice tool

602159 38 / 32mm Adaptor

601144 65mm Soft dusting brush

601141 Double taper hose / tool adaptor

601917 280mm Stainless steel gulper / scraper tool

Handle Assembly

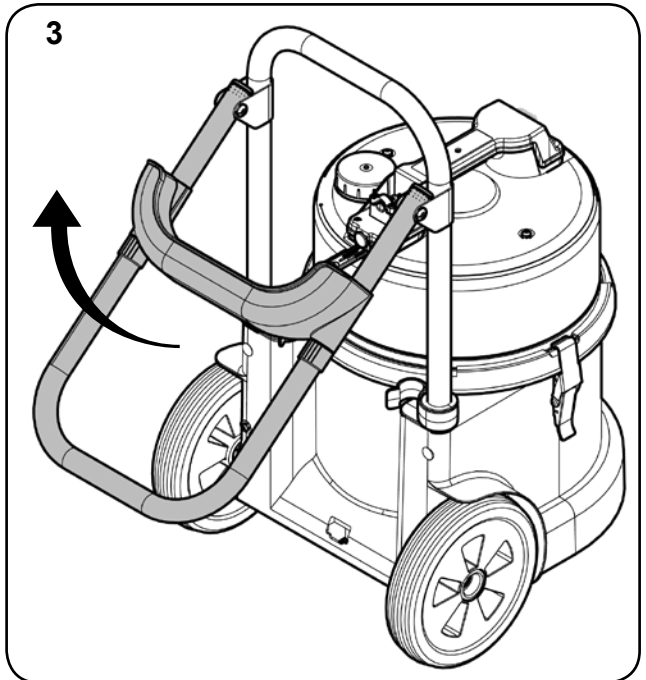
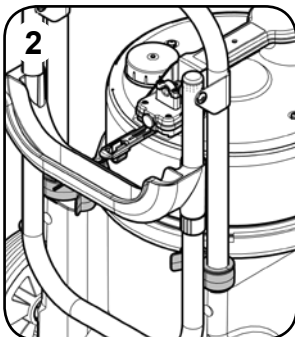
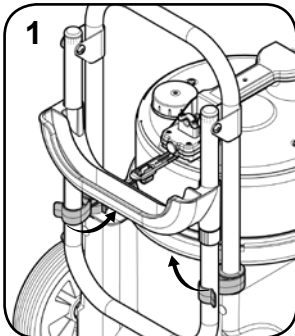

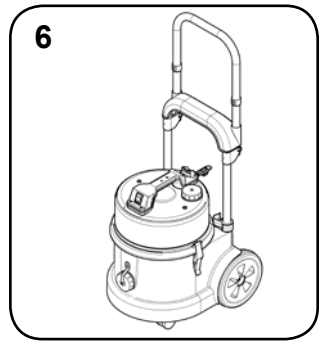
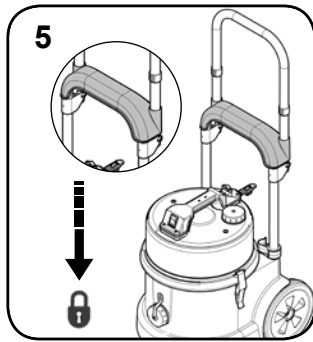
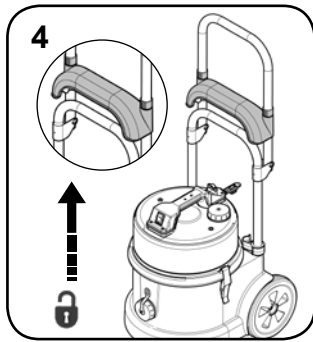

Air Diffuser

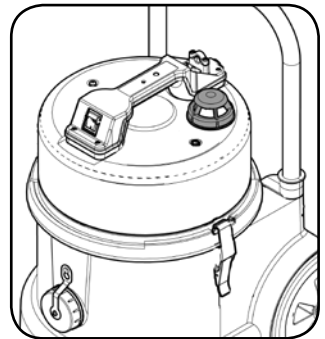
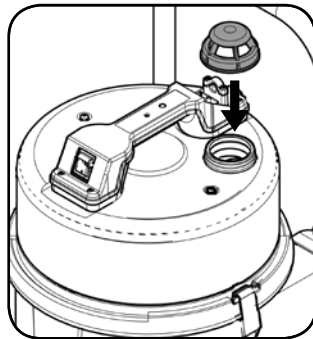
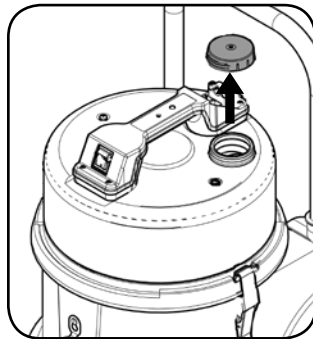

Hose

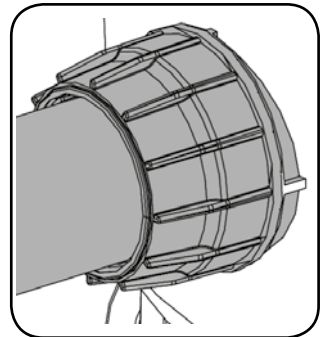
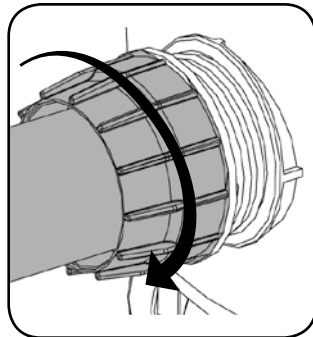
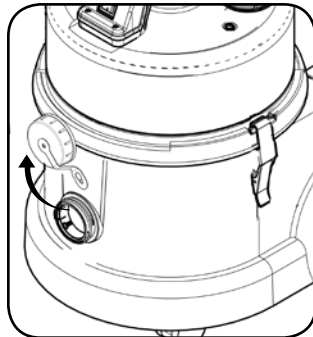

Machine Function

I **On**
- **-**
0 **Off**

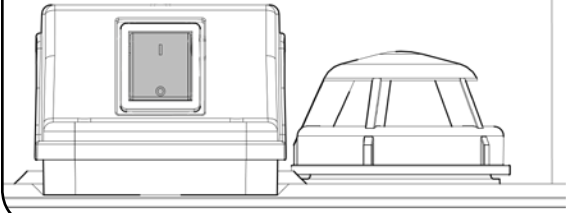
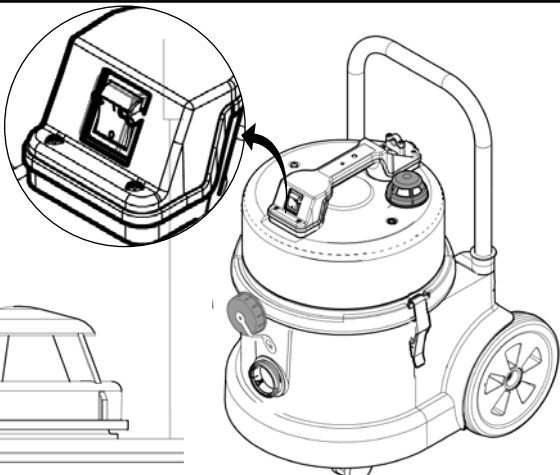

Moving your Machine

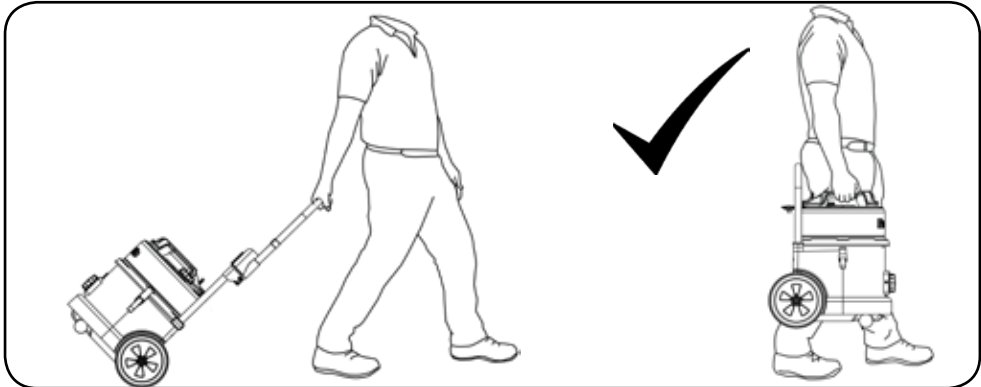
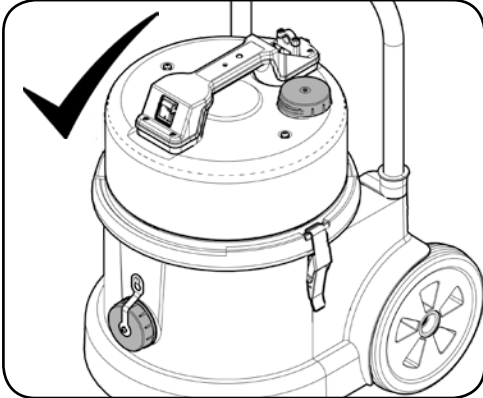
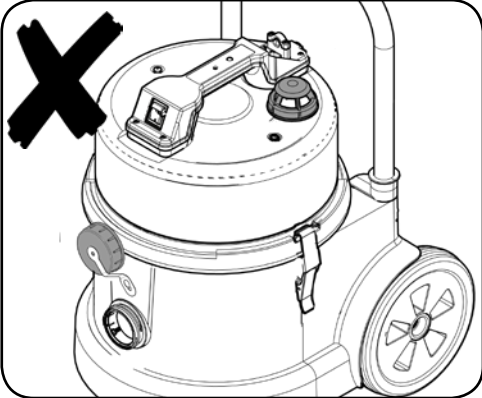

Replacing the Cartridge Filter

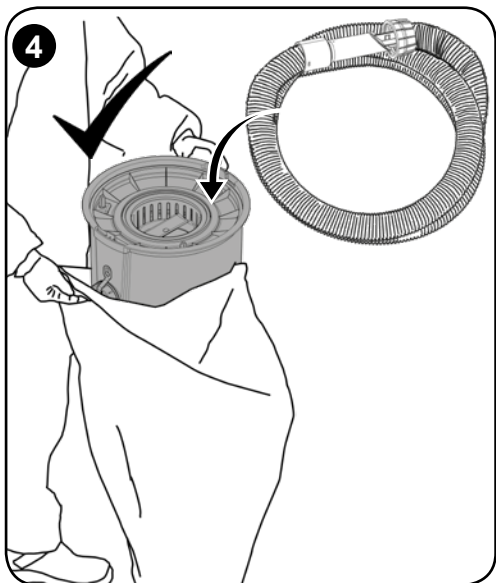
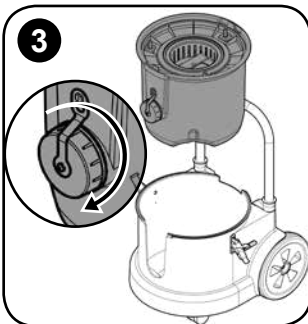
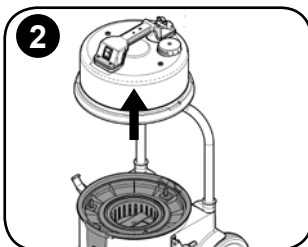
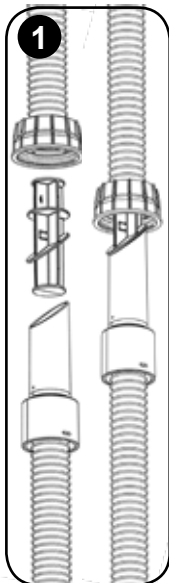
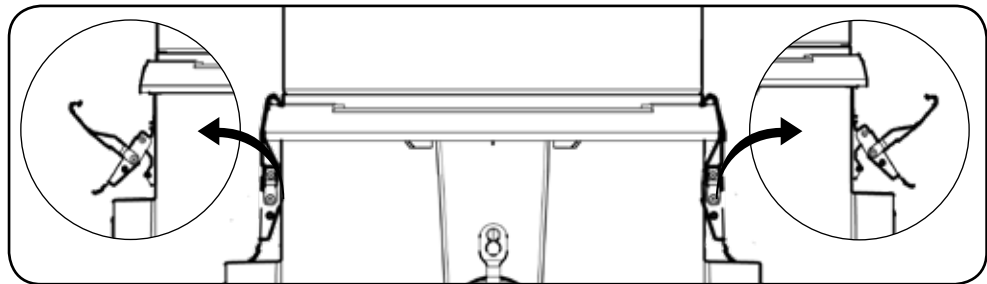

1. Seal contaminated hose using bung supplied.
- 2/3. Remove the sealed H Class Filter Unit from the drum.
4. Place the Filter Unit and Hose Assembly inside an impervious plastic bag and seal the bag.

Dispose of the plastic bag, depending on contamination, in an appropriate manner.

Note* Filter unit is sealed do not attempt to open and reuse.

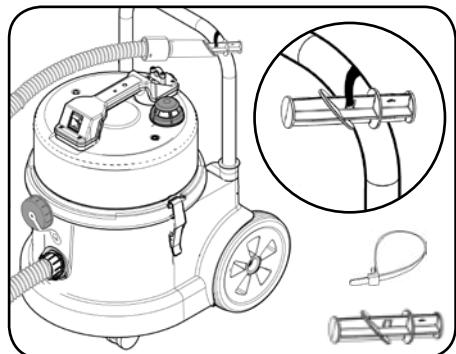
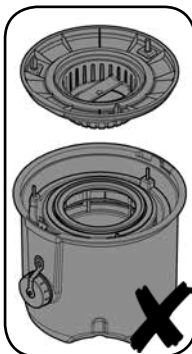
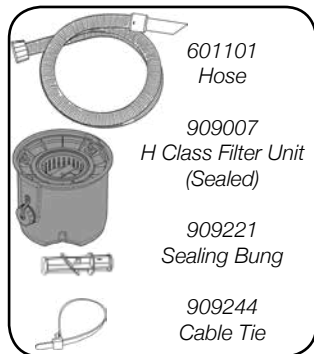

Low Flow Warning Light

Lo - Flo Indicator.

Slow Repeated Flash.

The vacuum cleaner is fitted with a warning lamp that will illuminate and flash when the air speed in the suction hose falls below $<20\text{m/s}$.

This indicates that the filter cartridge requires changing.

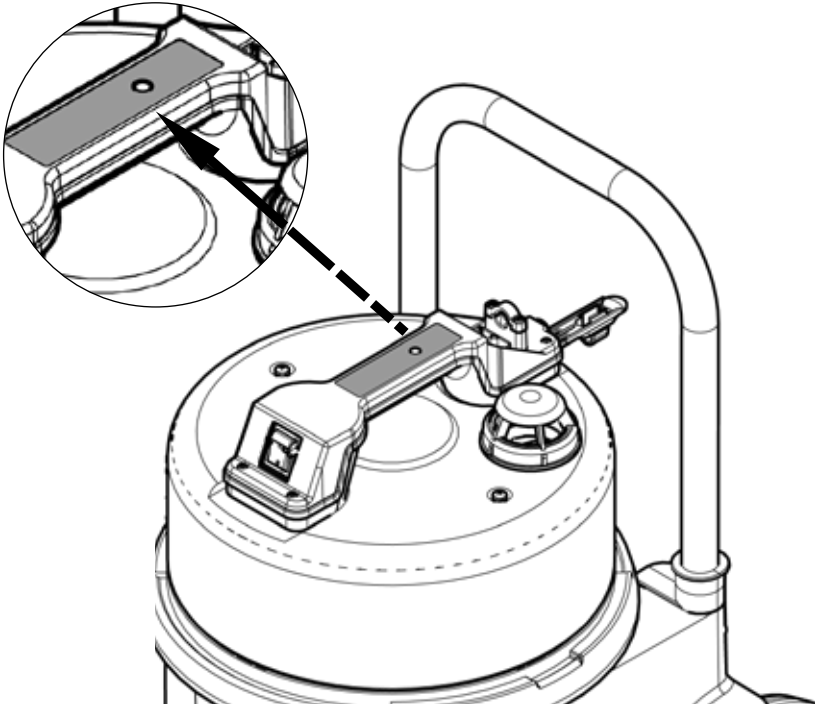

Cause	Solution
<i>Suction hose blocked or kinked.</i>	<i>Remove blockage or kink.</i>
<i>Filter clogged or blocked.</i>	<i>Replace filter cartridge.</i>

Changing / Replacing Cable

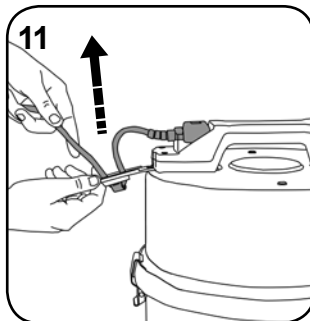
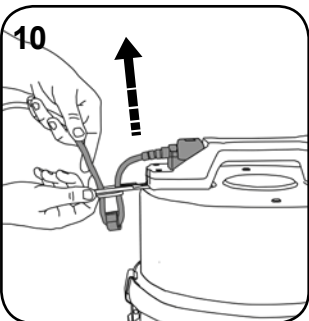
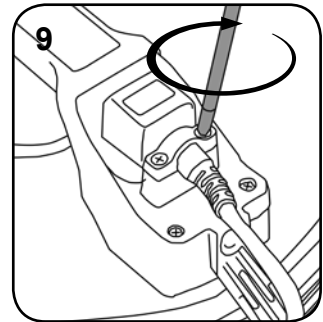
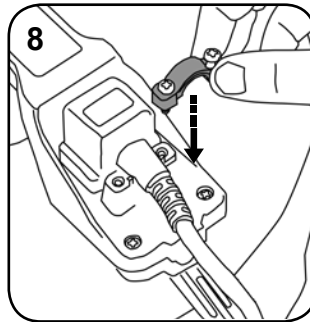
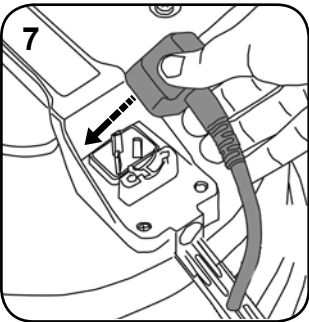
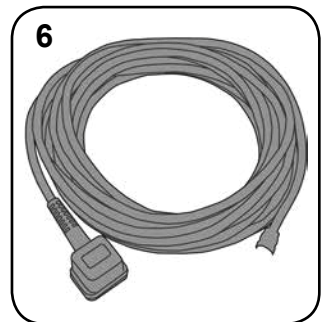
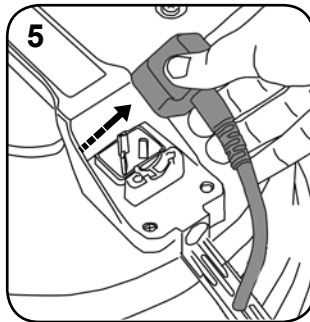
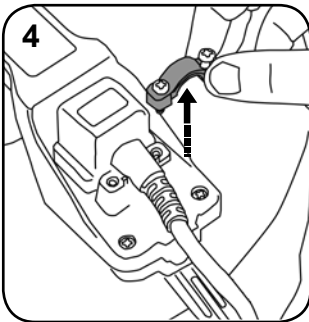
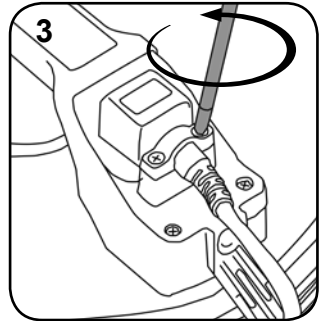
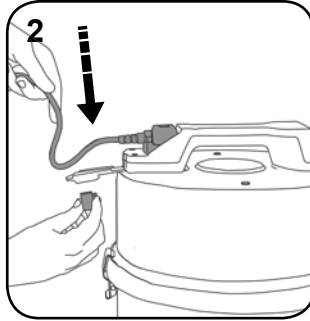
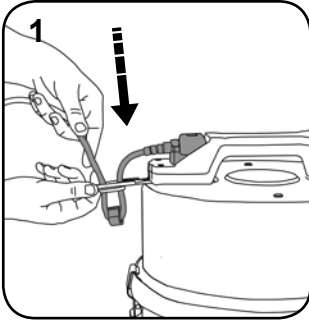

About the Machine

Rating Label

1	Company Name & Address
2	Machine Description
3	Voltage / Frequency
4	Power rating
5	IPX Rating
6	Weight (ready to use)
7	Type Hazardous
8	CE Mark
9	WEEE Logo
10	Machine yr/wk Serial number

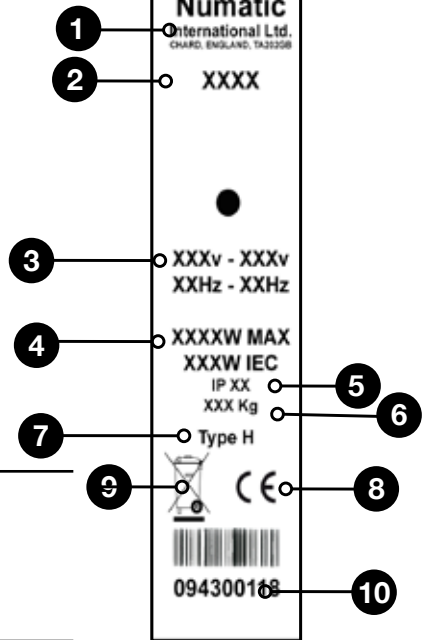

Safety Critical Component:

Mains Lead

H05VV-F 3 Core x 1.0mm² x 10m
(110V) H05VV-F 3 Core x 1.5mm² x 10m

WEEE (Waste, Electrical and Electronic Equipment)

Vacuum Cleaner Accessories and packaging should be sorted for environmentally-friendly recycling.

Only for EU countries.

Do not dispose of Vacuum Cleaner into household waste.

According to the European Directive 2012/19/EU on waste electrical electronic equipment and its incorporation into national law, vacuum cleaners that are no longer suitable for use must be separated, collected and sent for recovery in an environmental-friendly manner.



PPE (personal protective equipment) That may be required for certain operations.

Ear Protection	Safety Footwear	Head Protection	Safety Gloves	
				Caution Floor Sign
Eye Protection	Protective Clothing	Dust / Allergens Protection	Hi Viz Jacket	

NOTE: A risk assessment should be conducted to determine which PPE should be worn.

Information for DRY use Vacuum cleaners

WARNING!

*Read the instruction manual before using the machine.
Operators shall be adequately instructed on the use of these machines.*

As with all electrical equipment, care and attention must be exercised at all times during use, in addition to ensuring that routine and preventative maintenance is carried out periodically to ensure safe operation.

Failure to carry out maintenance as necessary, including the replacement of parts to the correct standard could render this equipment unsafe and the manufacturer can accept no responsibility in this respect.

*This machine is for DRY USE only and must not be stored outside or used in wet conditions.
The machine shall be disconnected from the mains by removing the plug from the supply socket during cleaning or maintenance and when replacing parts or converting the machine to another function.*

The machine is not to be used by children under 8 years old or persons with reduced physical, sensory or mental capabilities, or lack of experience or knowledge, unless they have been given supervision or instruction.

*Children should be supervised to ensure they do not play with the machine
This machine is not a toy.*

CAUTION

*Ensure that the filtration system fitted to the machine is suitable for the material being collected.
This machine is for dry use only.
This machine is for use indoors only.
This machine should be stored indoors only.*

NOTES

*This product complies with the requirements of IEC / EN 60335-2-69.
This machine is intended for commercial use, for example in hotels, schools, hospitals, factories, shops, rental businesses and offices for other than normal housekeeping purposes.*

DO

- *Keep your machine clean.*
- *Keep hoses and tubes clear.*
- *Replace any worn or damaged parts immediately.*
- *Regularly examine the power cord. If damage is found such as cracking or ageing the power cord must be replaced by a qualified person using the correct Numatic original part.*
- *Change 908082 H Class Filter Unit with the correct Numatic approved replacement part.*
- *Only use the brushes provided with the machine. The use of other brushes may impair safety.*
- *Only replace the power cord with the correct Numatic approved replacement part.*
-

DO NOT

- *Unreel the cable with one pull or pull on the cable to unplug the machine from the power supply.*
- *Use to suck up hot ashes or lighted cigarette ends.*
- *Use steam cleaners or pressure washers to clean the machine or use in the rain.*
- *Immerse in water for cleaning.*
- *Attempt machine maintenance or cleaning unless the power supply plug has been removed from the supply outlet.*

IMPORTANT USER INFORMATION

Before use operators shall be provided with information, instruction and training for the use of the machine and the substances for which it is to be used, including the safe method of disposing of material collected.

The cartridge filter has to be replaced when necessary.

This vacuum cleaner has a lamp that illuminates when air velocity drops below a preset level, which indicates that the cartridge filter must be changed.

This machine is not suitable for connection with dust generating machines.

The cartridge filter must be undamaged and in correct position before this machine can be used safely.

CAUTION: This machine is for dry use only and is not to be used or stored outdoors in wet conditions.

Do not pick up glowing embers or dust or any other ignition hazard

Do not use the power cable as a method of moving the machine.

WARNING:

1. This machine must only be operated by suitably trained and authorised personnel.
2. This machine or its accessories must not be modified.
3. The machine must not be stored or used in a wet environment.
4. Do not allow the cartridge filter to become so full as to reduce the effective pick-up of the vacuum. (Lamp will illuminate at preset air velocity levels < 20 m/s).
5. This machine must only be repaired by suitably trained and authorised personnel.
6. Only use genuine Numatic International Ltd spare parts, for repairs.
7. This machine must not be installed as a fixed extraction system or run unattended.
8. Do not re-use the essential filter element after removal out of the machine.



Operators should observe any safety regulations appropriate to materials being handled.

This machine is for dry use only.

PREPARATION FOR USE

Unpack and identify each item of equipment from the delivery note.

Check that the details given match the information on the "rating plate" mounted on the head assembly.

	<p>Warning: This machine contains dust hazardous to health. Emptying and maintenance operations, including removal of the dust collection means, must only be carried out by authorised personnel wearing suitable personal protection. Do not operate without the full filtration system fitted.</p>	
--	--	--

Installation / Removal / Disposal of the cartridge filter.

The cartridge filter holding the dust and debris must be removed and renewed by authorised personnel only, wearing appropriate personnel protective equipment, in a specified de-contamination area. Never operate without the full filtration system in place.

Process of disposal:

Disconnect the hose, fit the Dust Cap on the Hose Flange, un-clip the two Toggle Clamps.

Remove the cartridge filter from the Drum. Place the cartridge filter inside an impervious plastic bag and seal the bag.

Dispose of the plastic bag, depending on contamination, in an appropriate manner.

MAINTENANCE

All machine parts should be regarded as contaminated when removed from the hazardous area and appropriate action taken to prevent dust dispersal.

Disconnect from the power supply during cleaning, maintenance or when replacing parts.

Ensure the plug is removed from the socket outlet.

Maintenance must be carried out in a suitable non hazardous area with facilities for cleaning the area after servicing, and with suitable ventilation.

Maintenance and cleaning work must always be carried out by competent authorised personnel equipped with suitable personal protection.

The cartridge filter must be taken out and checked for degree of contamination, and damage to seals.

If the cartridge filter is found to be damaged or badly contaminated, you must replace.

Items that can not be satisfactorily cleaned (e.g. filter) need to be disposed of in an impervious plastic bag and disposed of in accordance with current regulations.

Replace the items that cannot be satisfactorily cleaned using approved manufacturer parts.

Regularly examine the supply cord for damage, such as cracking or ageing. If damage is found, replace the cord before further use.

All parts of this vacuum are safety critical only replace with the genuine Numatic spare parts.

For user servicing, the machine must be dismantled, cleaned and serviced, as far as is reasonably practicable, without causing risk to maintenance staff and others.

Suitable precautions include decontamination before dismantling, provision for local filtered exhaust ventilation where the machine is dismantled, cleaning of the maintenance area and suitable personal protection.

In class H machines the outside of the machine should be decontaminated by vacuum cleaning methods and wiped clean or treated with a sealant before being taken out of the hazardous area and appropriate action taken to prevent dust dispersal. (HSE Risk Assessment needed).

A qualified person must perform at least once a year - or more frequently if national requirements dictate - the filtering efficiency of the filter cartridge must be checked, or the filter cartridge must be replaced, a filter inspection to look for signs of damage, checking the tightness of the machine and correct operation of the control mechanism.

Also the filtration efficiency should be tested at least annually, or more frequently as specified in national requirements.

The test methods that can be used to verify the machine's filter efficiency are specified in EN 60335-2-69 Annex AA (AA22.201.2). If the test fails it should be repeated with a new cartridge filter.

*In the event of a breakdown contact your Numatic dealer
or the Numatic Technical help line +44 (0)1460 269268*

Daily

Keep the machine clean, including hoses and tubes.

Ensure the bag and filter are fitted.

Regularly examine the power cord.

Check dust bag frequently.

Check filters are clean.

Weekly - as daily and:-

Check for any worn or damaged parts and replace immediately.

Do not steam clean or pressure wash.

Replacement Parts

909007

*H Class Sealed Filter Kit***Data**

	Drum Size	Cleaning Range	Weight (Ready to work)	Sound Pressure	Protection Class
HZC 390S-2	13 Ltr	26.8 m	12.2 kg	68.76 dB (A) Uncertainty 0.5 dB	Class I
HZC 390L-2	13 Ltr		13.0 kg		
Dimensions L x W x H	Low flow operation	Voltage Frequency	Power Rating	Max. Under pressure	Max. Flow rate
(S) 450 x 400 x 600mm (L) 450 x 400 x 1010mm	< 20 L/sec	110V 220-240V 50-60 Hz	1000W IEC 1000W MAX	230 Mbar 230 (hPa)	31.8 L/s 114.5 m ³ /h

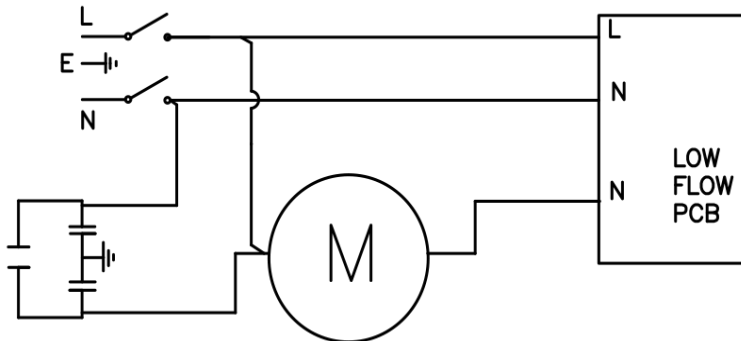
Schematic Diagram

Numatic International Warranty

Numatic International Limited warrant to the original purchaser that its products are free of defects in both material or workmanship for the period shown below:-

Homecare and Cleancare Vacuum cleaners.....	2 Years
Rotary Floor Machines.....	2 Years
Twintec Auto Scrubber Dryer.....	1 Year
Mopping, Compacts, Combi and Servocare Products.....	1 Year
Individual Accessories and Spare Parts.....	6 Months

Note: This warranty expressly excludes consumable parts such as carbon brushes, floor brushes, mops, batteries etc, that are considered replaceable from time to time during the normal working life of the machine.

A. The warranty period commences from the date the goods are purchased.

B. All warranty claims must be processed through the Dealer from whom the equipment was purchased. The Dealer will co-operate with the purchaser throughout the warranty claims procedure and will arrange any necessary repairs using genuine Numatic parts.

C. If the original Dealer is no longer able to fulfil his obligations please contact Numatic International Limited with full details of the claim and proof of purchase so that this may be processed without delay.

D. Any warranty claim can only relate to the specific part that is proven to be at fault and for which a replacement will be supplied but cannot be extended to constitute a claim against the complete machine.

E. Numatic International will supply the Dealer with any warranty parts required, subject to the claim being validated, after return of the faulty items in accordance with Numatic International Limited's General Conditions of Sale.

F. Claims will not be accepted if they are the result of fair wear and tear, misuse or abuse of any kind.

G. No replacement will be given unless the appropriate evidence of the validity of the claim has been provided to the satisfaction of Numatic International Limited.

H. Numatic International Limited reserve the right to charge for any unnecessary work carried out as a result of an invalid claim.

I. No variation to this warranty may be made or implied by any member of Numatic International Limited or its Dealers unless such variation is in writing and authorised by the Company.



Numatic International Limited. Chard, Somerset, TA20 2GB

Telephone: 01460 68600 Fax: 01460 68458

© Numatic International Limited 2016



**EU DECLARATION
OF
CONFORMITY**

We hereby declare under our sole responsibility that the following equipment fulfils all the relevant provisions of the following EU Directives

Machinery Directive 2006/42/EC
EMC Directive 2014/30/EU
RoHS Directive 2011/65/EU

Machine Description: Vacuum Cleaner
Machine Type: HZ, HZD, HZC Series.

Relevant standards upon which conformity is declared include:

EN 60335-1: 2012 + A11:2014
EN 60335-2-69: 2012
EN 55014-1: 2006 + A1:2009 + A2:2011
EN 55014-2: 1997 + A1:2001 + A2:2008
EN 62233: 2008

A technical construction file for this equipment is retained at the manufacturer's address under the authorisation of the following signatory:

Name: Allyn Boyes Position: Development Manager

Signed

Date

2/10/18



Numatic International Ltd
Chard Somerset
TA20 2GB
www.numatic.co.uk

GB

Notes

A series of horizontal dotted lines for writing notes, consisting of 25 rows of evenly spaced dots.



Distributed by:

Affix label here

Numatic International Limited.
Chard, Somerset TA20 2GB ENGLAND
Tel.: 01460 68600 **www.numatic.co.uk**

Specification subject to change without prior notice
www.numatic.co.uk © Numatic International Limited

908545 01/19 (A04)